

FACILITY RENTAL

ROOM DETAILS



Room Name:	Whistlestop Room
Room Size:	1230 square feet 42ft x 48ft (not even on all sides)
Capacity:	Seated dinner: 80 Standing reception: 150 Theater: 90 Boardroom: 36
A/V Hardware:	2 overhead projectors 2 projection screens 3 HDMI input port locations

FACILITY RENTAL

ROOM DETAILS

	Up to 4 Mics
Pricing:	\$1,000 for up to 100 people
	\$500 for up to 50 people
Special Notes:	<p>*Part of the “East Wing” conference rooms.</p> <p>*This room connects with the Independence Room for multi-room events or larger events.</p>

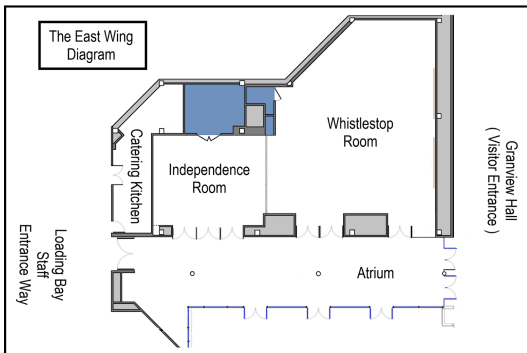

Diagram of the East Wing

